



SPECIFICATION :

1. Electrical Char.

Insulation Resistance : 500M-Ohm Min.
 Contact Resistance : 20milli-Ohm Max.
 Rating Current : 1.5A Max.
 Rating Voltage : 120V AC
 Dielectric Voltage : 1,000 Vrms 60 Sec. Min.

2. Physical char.

Housing : PBT Glass Filled (UL 94V-0)
 Color : Black Color
 Spring Wire : 0.45mm Dia. Phosphor Bronze
 Gold Plating Over Nickel
 Temperature Range : - 25 /+90 Deg C
 Durability : 500 Mating cycles Min.

AJ-012-6-X-X-N ← **FLANGELESS**

B=6p2c , C=6p4c
 D=6p6c

Gold plated 1=15u , 2=30u
 3=50u , 4= 6 u

ALLSUN CORPORATION
 9FL,NO.292 SEC.7 CHENG TEH ROAD.TAIPEI TAIWAN.
 E - mail Address : allsun @ globalsources. com

TITLE
RJ11 or RJ12 TOP ENTRY PCB JACK
 UL & cUL FILE NO. E131820

MODULAR JACKS ASSY FOR
AJ-012-6-X-X-N

SCALE SIZE DWG. NO. 9607 SERIES

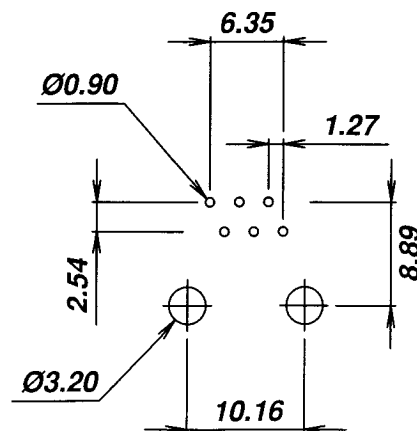
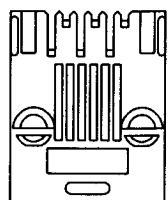
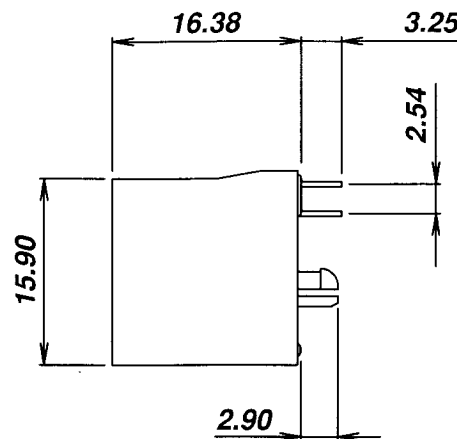
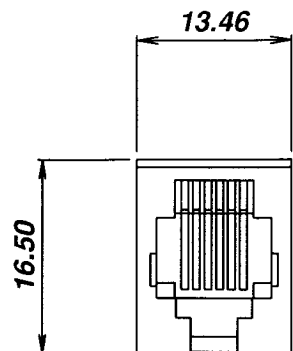

PCB LAYOUT
 (Top View)

NOT SCALED DRAWING	TOLERANCE UNLESS OTHERWISE NOTICE	INCH	MM	DR.	DATE
 THIRD ANGLE PROJECTION	LINEAR $\frac{MM}{INCH}$	00±0.01	00±0.25	Steven	AUG-23 '04
		000±0.005	000±0.13	Johnn	AUG-23 '04
	ANGLE +0°30'	RADIL	+0.45 -0.15	Billy	AUG-23 '04

DWG. NO. **AS012004**